

# PERFORMANCE ROPE HOLDING

Easy to use, can be fastened and released with one hand and operated from a distance.

Uses a single piece of rope.

Uses include aiding installation of machinery and heavy duty cables.



CL719

## Trucker Hitch Cleat

**Trucker Hitch Cleat**  
CL719 (Nylon)

An aerial cleat that rigs like the trucker's hitch / wagoner's hitch.

mm Ø inch Ø	A B C			mm Ø inch Ø	mm Ø Gauge	Gms Ozs
	A	B	C			
5 - 7 3/16-9/32	139 5 1/16	-	28 1 7/16	-	-	73 2.6



## Shockcord products for ropes to 8mm (5/16")

**Rigid Inflatable Boat Hook**  
PT401 & PT401W (Acetal)

**Shockcord Ball**  
PT402 & PT402W (Polypropylene)

**T-Bar for shockcord**  
PT403 (High density polyethylene)

**Hook for shockcord**  
PT404 (High density polyethylene)

**Hook Connector for shockcord**  
PT405 & PT405W (Nylon)

mm Ø inch Ø	A B C			mm Ø inch Ø	mm Ø Gauge	Gms Ozs
	A	B	C			
3 - 6 1/8-1/4	39 1 1/2	-	38 1 1/2	-	-	9 0.32
5 - 7 3/16-9/32	19 3/4	-	20 25/32	-	-	4 0.15
4 - 6 5/32-1/4	43 1 11/16	-	10 12/32	-	-	1.2 0.04
5 - 7 3/16-9/32	50 1 31/32	-	23 29/32	-	-	4 0.15
4 - 8 5/32-5/16	57 2 1/4	-	25 1	-	-	8.2 0.29



## Cleats for tubes to 43mm (1 11/16")<sup>Ø</sup>

**Cleat and integral Clamp**  
CL235 (Nylon)

**Boom Cleat and Clamp**  
CL243/S5 (Nylon)

**Boom Cleat and Clamp**  
CL244+CL105 (Aluminium & Nylon)

**Boom Cleat and Clamp**  
CL244+CL111 (Aluminium & Nylon)

**Boom Cleat and Clamp**  
CL244+CL115 (Aluminium & Nylon)

**Boom Cleat and Clamp**  
CL244+CL134 (Aluminium & Nylon)

**Bar Cleat**  
CL265  
CL265AN (Aluminium & Stainless Steel Clamp)

mm Ø inch Ø	A B C			mm Ø inch Ø	mm Ø Gauge	Gms Ozs
	A	B	C			
3 - 6 1/8-1/4	67 2 5/8	-	36 1 11/16	30-32 1 1/8-1 1/4	-	17 0.6
3 - 6 1/8-1/4	58 2 1/4	-	-	20-21 13/16	-	28 1.0
3 - 5 1/8-3/16	58 2 1/4	-	-	30-32 1 1/8-1 1/4	-	32 1.1
3 - 5 1/8-3/16	58 2 1/4	-	-	32-35 1 1/4-1 3/8	-	32 1.1
3 - 5 1/8-3/16	58 2 1/4	-	-	35-37 1 1/8-1 7/16	-	32 1.1
3 - 5 1/8-3/16	58 2 1/4	-	-	42-43 1 11/16	-	32 1.1
4 - 8 5/32-5/16	63 2 1/2	66 2 5/8	18 1 1/8	25-31 1-1 1/4	-	60 2.1

The alloy cleat is fitted onto the boom by a strap that allows you to personalise the position, a rubber packing piece accommodates slight tube differences.

Fitting CL244 with CL105, CL111, CL115 or CL134 clamps.

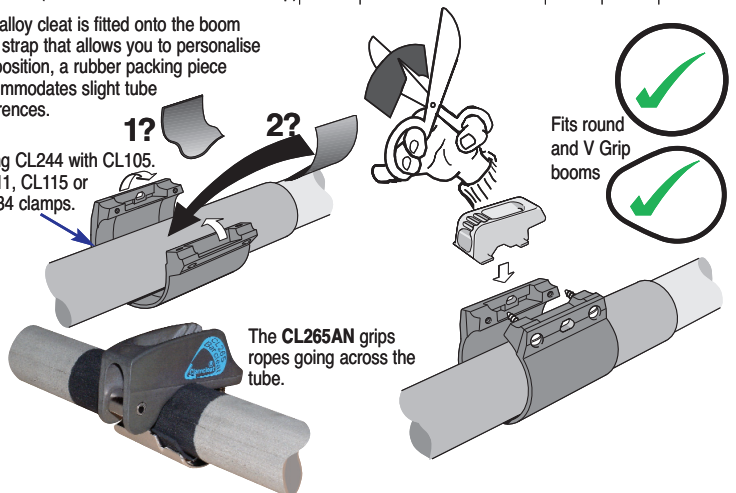

The CL265AN grips ropes going across the tube.

Fits round and V Grip booms



CL243+  
CL072

CL235